

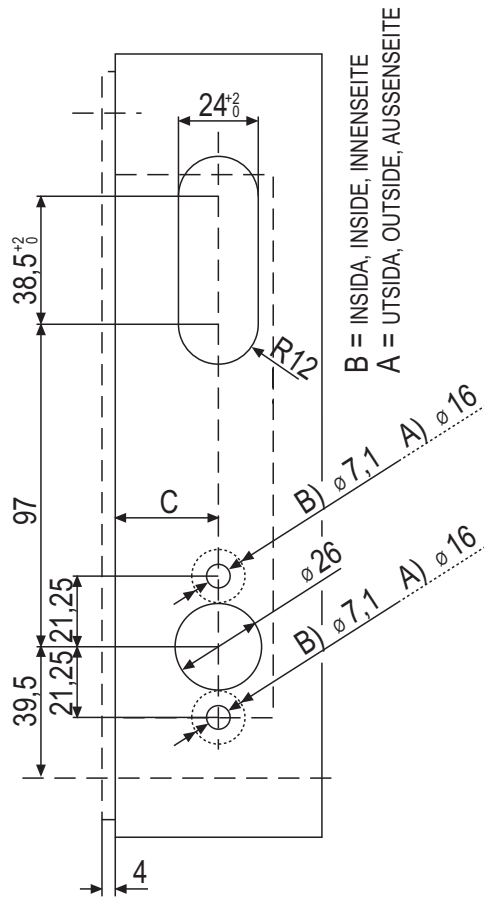

BORRSHEMA
DRILLING SCHEME
BOHRSCHEMA

LC300, LC301
LC301F, LC302
LC303, LC305

Var god, jämför måtten i borrschemat med själva låsets mått.
Please check drilling scheme dimensions with actual dimensions on lock.
Bitte Masse im Bohrschema mit Abmessungen am Schloss selbst vergleichen.



B = INSIDA, INSIDE, INNENSEITE
A = UTSIDA, OUTSIDE, AUSSENSEITE

UTSIDA
OUTSIDE
AUSSENSEITE

INSIDA
INSIDE
INNENSEITE

FRAMSIDA
FRONT
VORDERSEITE

KARM
FRAME
RAHMEN

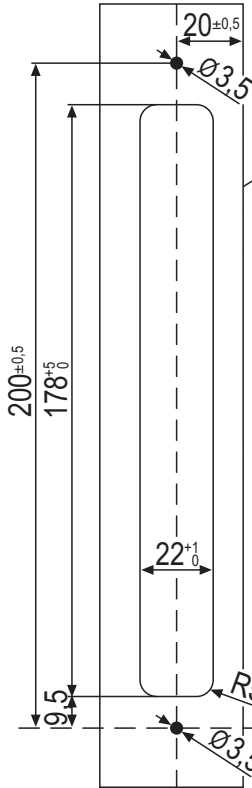

Öppningssida
Opening face
Öffnungsseite

4613, 4614

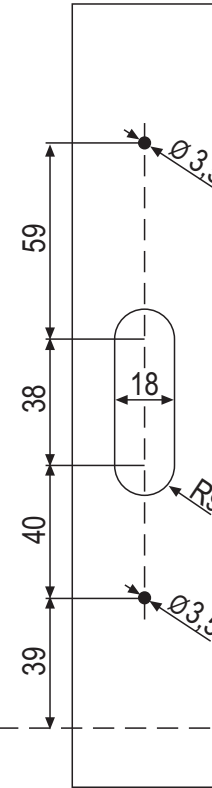

4613, 4614 +8400

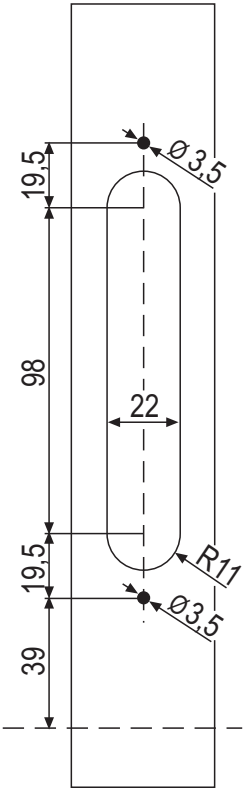

4613: 2,5
4614: 5

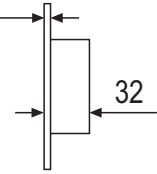

LC300, -1, -2, -3, -5 / 30,5 C=26,5
LC300, -1, -2, -3, -5 / 35 C=31

Tolerances +0,5/-0

2139	/	LC302	/	4613, 4614 (+8400)	/	CY067		ME207	/	LC302	/	4613, 4614 (+8400)	/	CY047, CY045*	/	Handle, pull**
2239, ME204	/	LC301	/	4613, 4614 (+8400)	/	CY067, CY044*		ME209	/	LC303	/	4613, 4614 (+8400)				
2338, ME206	/	LC302	/	4613, 4614 (+8400)	/	CY067, CY044*		ME211	/	LC305	/	4613, 4614 (+8400)	/	CY067, CY044*		
2339, ME208	/	LC302	/	4613, 4614 (+8400)	/	CY068		ME212	/	LC305	/	4613, 4614 (+8400)	/	CY047, CY045*		
2537, ME205	/	LC302	/	4613, 4614 (+8400)	/	CY066, CY014*		ME213	/	LC305	/	4613, 4614 (+8400)	/	CY068		
2538, ME203	/	LC300	/	4613, 4614 (+8400)	/	CY066, CY014*		ME218	/	LC301	/	4613, 4614 (+8400)	/	CY047, CY045*		
2539, ME210	/	LC305	/	4613, 4614 (+8400)	/	CY066, CY014*		LC303	/	4613, 4614 (+8400)						

* Hardened outside cylinder ring

** See ABLOY Architectural hardware range

